

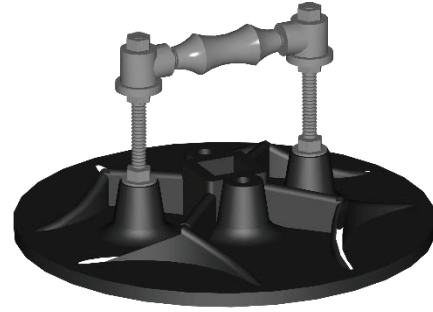

# RB-18 WITH ROLLER

## SPECIFICATION & TECHNICAL INFORMATION SHEET



### DESCRIPTION:

The PHP Support is designed to support gas lines from 3" to 5" in diameter, not exceeding 12" in height and a minimum height of 5". The support is designed for installation without roof penetrations, flashing, or damage to roofing material. The system can be used on virtually any roofing system. The supports should be spaced according to specs, not to exceed 10' o/c. For Seismic and High Wind applications, PE calculations will be required, along with incorporating restraints into the system.

### INSTALLATION PROCEDURE:

#### New Pipe

- 1 | Layout isolation pads, (provided by contractor), according to the design and layout.
- 2 | Layout RB18 with roller supports per spacing specifications or PHP layout.
- 3 | Run pipe on roller.
- 4 | Adjust roller height, so weight of system is evenly distributed.

#### Retro-fit

- 1 | Lift pipe, (enough to remove existing support).
- 2 | Clean area where new support is to be placed.
- 3 | Place ISO pad, (provided by contractor).
- 4 | Place RB18 with roller support on pad.
- 5 | Lower pipe on roller.
- 6 | Adjust roller height, so weight of system is evenly distributed.

### STORAGE:

Store in the original, unopened containers, under cover, until needed for installation.

### LEED INFORMATION:

Frame/Steel  
Post Consumer Recycled Content: 0%  
Post Industrial Recycled Content: 25%

### BASE MATERIAL:

Post Consumer Recycled Content: 80%  
Post Industrial Recycled Content: 20%  
Manufacturing Location: Houston, TX

### PRODUCT DATA:

#### Property:

##### Base:

|                |   |
|----------------|---|
| Size:          | 18" round   |
| Base Weight:   | 10-1/2 lbs  |
| Base Material: | Injection molded high density/high impact polypropylene with UV-inhibitors and Antioxidants |
| Base Color:    | Black   |
| Base Density:  | 55.8 lb/cu ft (894 kg/cu m)   |

#### Minimum Performance:

#### Rod Type:

|           |   |
|-----------|---|
| Diameter: | 5/8"                                      |
| Length:   | 8" - 12"                                  |
| Finish:   | Hot Dip Galvanized or 304 Stainless Steel |

#### Carbon Steel:

|              |  |
|--------------|--|
| Roller Type: | 5" cast iron roller with Malleable sockets |
|--------------|--|

Carbon Steel Finish: Hot Dip Galvanized per ASTM A 123

#### Hardware:

|                   |   |
|-------------------|---|
| Nuts and Washers: | Hot Dip Galvanized or 304 Stainless Steel |
|-------------------|---|